

EH-VS PROLINE

Linear waterproof luminaire

LED |



Installation Instructions



For illustration only



Technical data:

- IP65
- Electrical protection class: Class I

Disconnect mains power before installation.

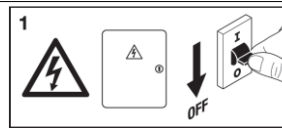

Important:

This light fixture is classified as electrical & electronic waste (WEEE). Once ceased operation It is mandatory to destroy it according to your local waste directives.

Warning:

1. Connecting this light fixture to mains will be conducted only by qualified and licensed electrician. It is mandatory to disconnect mains supply prior to installation or service.
2. Replace any broken protective cover.
3. This light fixture is designed for indoor and outdoor installation, according to listed IP level.
4. The usage of non-complying dimming devices for low voltage systems may damage the power supply device.
5. The light fixture must not be covered by any isolation material.
6. This light fixture may be connected by concatenated connection of luminaires:

Size (length) (cm)	Output power (W)	Circuit Breaker (A)	Max. number of luminaires connected
60	18	10	90
120	36	10	45
150	50	10	35

Maintenance:

1. Use only a soft antistatic wipe to clean the diffuser.
2. In case of a fault, do not try to fix it on your own. Uninstall the light fixture and contact your nearest official service station.
3. Do not use Alcohol, detergents, chemical and such to clean the light fixture.
4. The light source unit is non-replaceable.

Electrical wiring scheme:

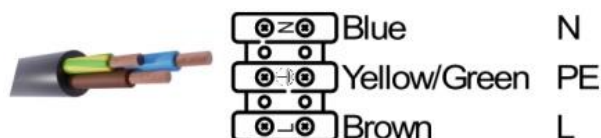

Installation instructions:

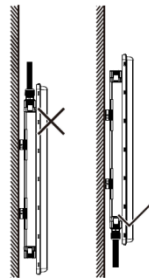
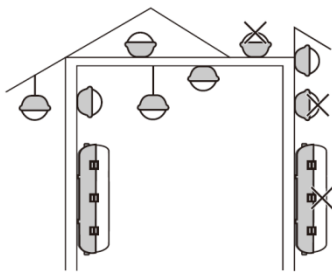

	A	B	C	D	E min	E max	H
WF-600	68	555	70	38	140	260	80
WF-1200	68	1155	70	38	740	860	80
WF-1500	68	1455	70	38	1040	1160	80

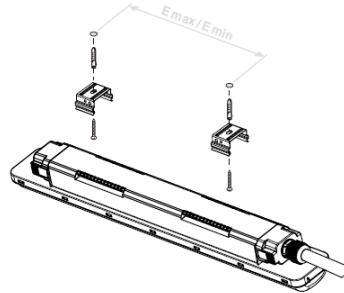
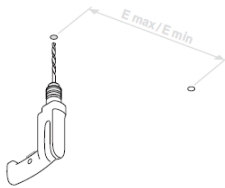
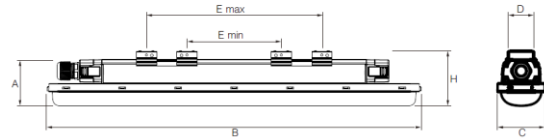

Length	E max	E min
2FT	260mm	140mm
4FT	860mm	740mm
5FT	1160mm	1040mm

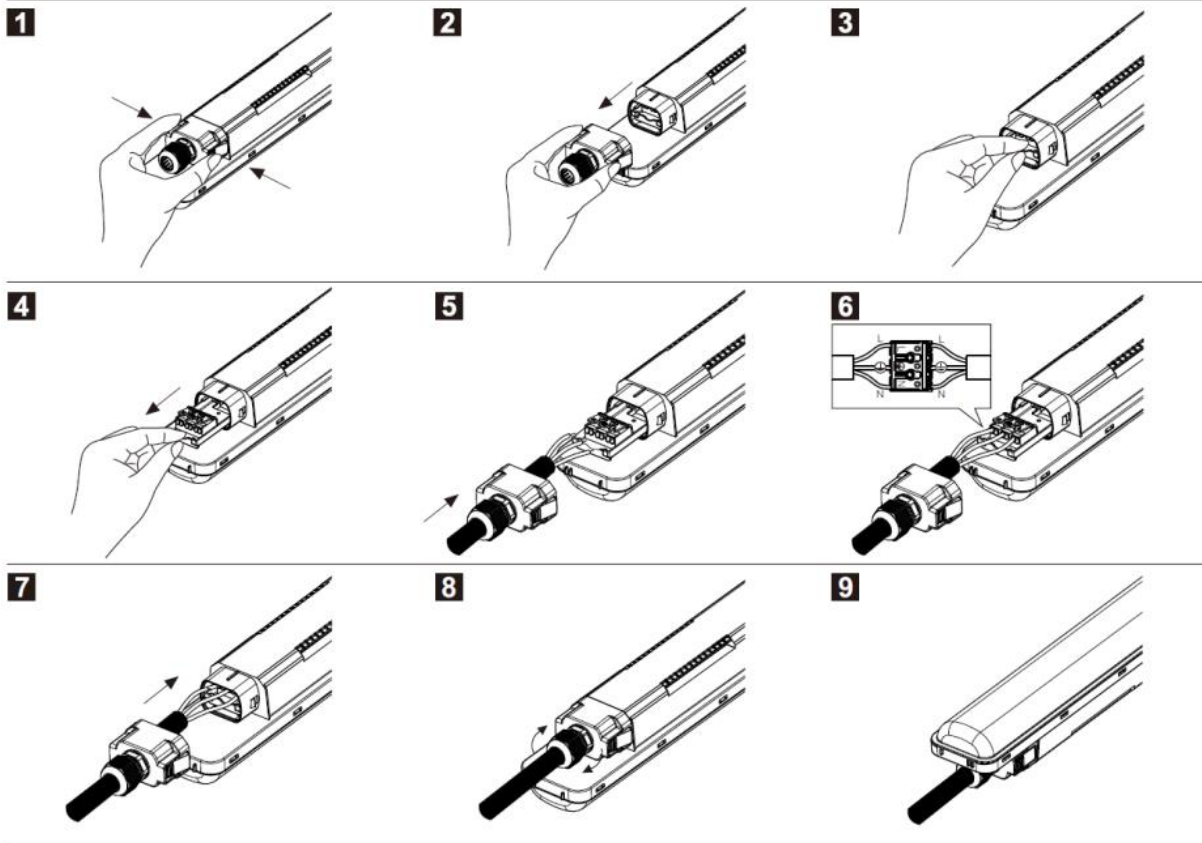

We hold our rights to change and update technical data on luminaires without prior notice. Although all efforts conducted in accessibility of data, inaccuracies and/or typographical errors may occur. Instructions are worded in the masculine language for convenience only, and refer to all genders. Warranty is valid according to the enlisted data on our website, and/or as listed on client quotation, by our local representative.